

Gwynedd Wildlife Preserve

640 South Swedesford Road, Ambler, PA 19002
610-353-5587 x503 www.natlands.org

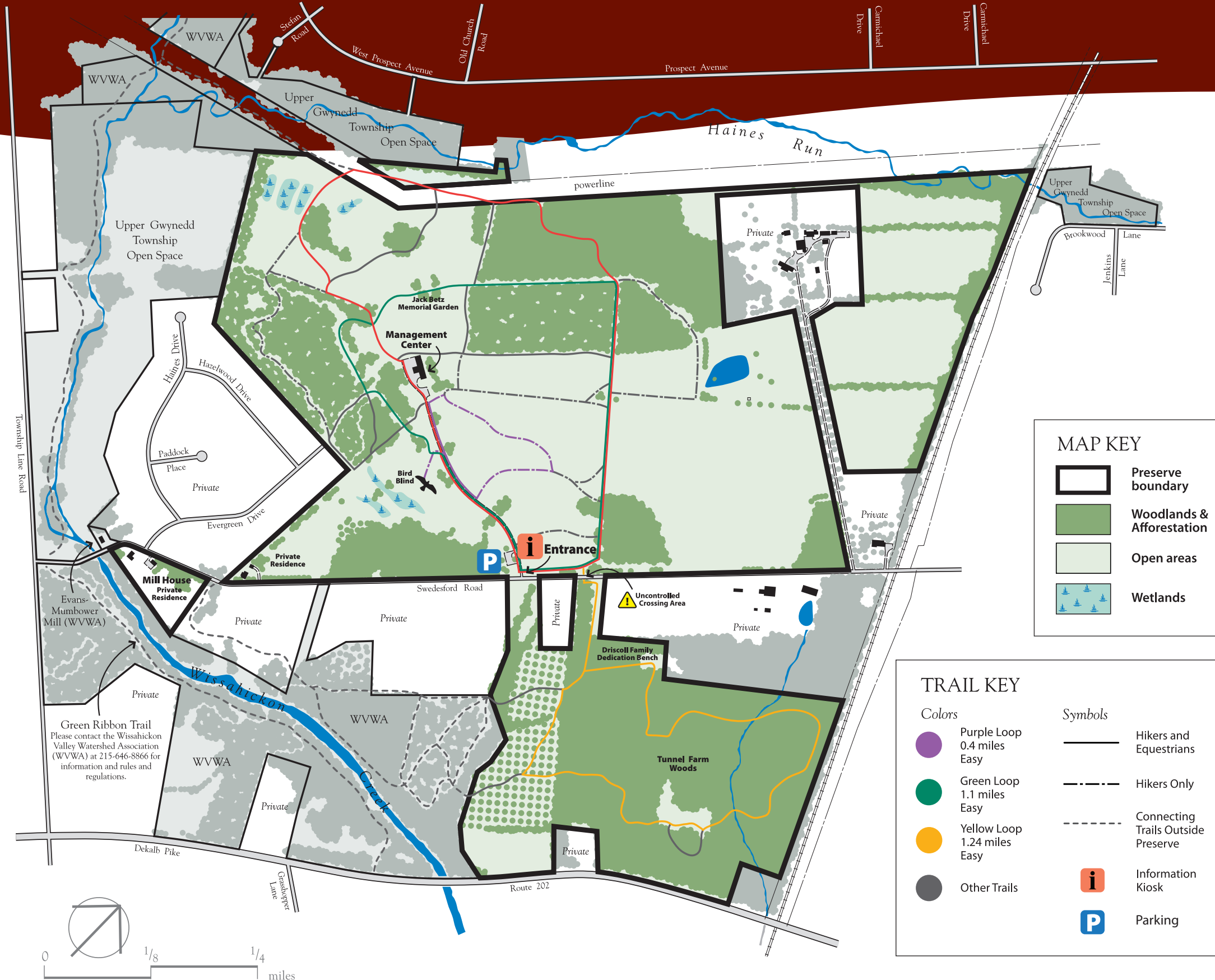

Join your fellow preserve visitors in helping to protect this special resource!

PRESERVE IS OPEN SUNRISE TO SUNSET ONLY

MANAGE YOUR DOG

Keeping your dog in control keeps people, other dogs and wildlife safe. Dogs must be leashed at all times on the preserve.



PICK UP POOP

Dog poop is a health hazard. It also increases the nitrogen in the soil, making it hard for native plants to survive, and contributes to water pollution. Please pack a pick-up bag and always clean up your dog's poop—wherever it's left.

TRASH YOUR TRASH

Please pick up all trash—yours and others'. Even biodegradable materials such as apple cores and orange peels take years to break down and attract scavengers that can harm native wildlife. Trash is unsightly and ruins everyone's outdoor experience.



PLEASE ALSO NOTE...

- Hunting, fishing, and trapping are prohibited. Deer hunting by permit only. Contact the preserve manager for more information.
- Stay on designated trails. Please stay out of the creeks, ponds and wetlands. Swimming is prohibited.
- Do not disturb research and education activities or remove any plants, animals or rocks. To avoid damaging sensitive research, do not enter areas marked "Authorized staff only."
- Please respect the privacy of those who live on and adjacent to the preserve.
- No motorized vehicles or mountain bikes. Horseback riding by permit only. Contact the preserve manager for more information.
- Picnicking is not permitted anywhere on the preserve. Alcoholic beverages and controlled substances are prohibited.



Natural Lands Trust encourages visitors to learn about and follow Leave No Trace's principles for low impact use of natural areas. www.LNT.org